

ACL reconstruction

High quality implants for YOUR technique



PULLUP[®]

Adjustable juxtacortical fixation



LIGAFIX[®]

Bioabsorbable interference screws



TRANSLIG[®]

Strong and stiff femoral fixation





SBM: your partner in bone healing

Founded in 1991, SBM is specialized in the design, manufacture and marketing of bone repair systems for use in orthopaedic surgery, traumatology and neurosurgery.

More than 20 years of experience

SBM is an independent company, founded by Denis CLEMENT, PhD in Biomaterials. Based in Lourdes (south-western France), SBM has a subsidiary in Boston, Massachusetts (USA), SBM Inc.

At the heart of innovation

Not only was SBM the first company to introduce tricalcium phosphate to perform bone grafts in Europe, but also was the first, in 1996, to invent implants for valgus-producing open-wedge tibial osteotomies.

Today SBM continues to stand out for its unique know-how in the manufacture of biocomposite implants such as Duosorb, a unique bioabsorbable material which offers mechanical resistance, elasticity, and osteoconduction.

Proven high quality standards

Having expanded into new markets with increasingly strict regulations, SBM has developed a demanding, ISO 9001-13485 (2000) certified quality management approach, which ensures product safety all the way from design to implementation.

Furthermore, SBM was the first European company to obtain CE mark certification, in the 90's, as well as US FDA approval, in 2003, for its line of synthetic bone augmentation implants (in pure tricalcium phosphate - Biosorb).



Worldwide network

- ▶ Over 20% of revenue invested in R&D each year
- ▶ Full range of expertise: implants, instruments & techniques
- ▶ Present in more than 45 countries worldwide



Design

With over 20% of its revenue invested in Research and Development each year, SBM is well positioned for growth through a continued focus on innovation. Renowned for its know-how, the company is also active in the development of OEM products.

SBM designs its own devices, thanks to a research team composed of doctors, engineers, technicians and associated scientists with mutually complementary specialties, such as biology, engineering, ceramics, chemistry, plastics and biostatistics. By developing lasting partnerships with high-level surgeons from all over the world, SBM stays abreast of the most current issues and on the cutting edge of the latest developments in skeletal surgery. Our consultants' competence, clinical experience and reputation enable us to continually improve our products for simplified, repeatable use.

Manufacturing

Over time, SBM has developed specific and original procedures that guarantee high-quality implants. SBM produces a wide variety of implants made of ceramic, composite and metallic materials, as well as associated instruments. Each year over 60,000 SBM implants are manufactured and used in 45 countries.

Certified by independent organizations, the company implements the strictest standards, and is regularly audited to ensure that its methods are in compliance with regulatory requirements.

SBM operations are traced throughout all stages of production, distribution and use, which provides increased visibility and significantly contributes to patient safety.

Distribution

SBM is present both in France and abroad, via a network of partners in 45 countries on all 5 continents. Today, 80% of the company's production is intended for export.

Thanks to the many partnerships SBM has developed around the world, permanent postmarket functional and clinical evaluations of SBM devices are carried out to continuously optimize their performance levels.

SBM organizes exhibits each year at major scientific congresses both in France and abroad, in an effort to anticipate future challenges associated with the surgical indications for which we offer solutions.

With 22 years of experience, the company has built a tight network of partners, surgeons and distributors in France and abroad over the years. SBM's sales team provides attentive customer service which includes support and training to surgeons, hospital staff and distributors.

SBM partnerships are driven by a shared vision of improving patients' well-being and by encouraging exchanges among surgeons from different countries to develop new solutions to promote bone healing.

What is your technique for ACL reconstruction?

We have the right fixation option for you.

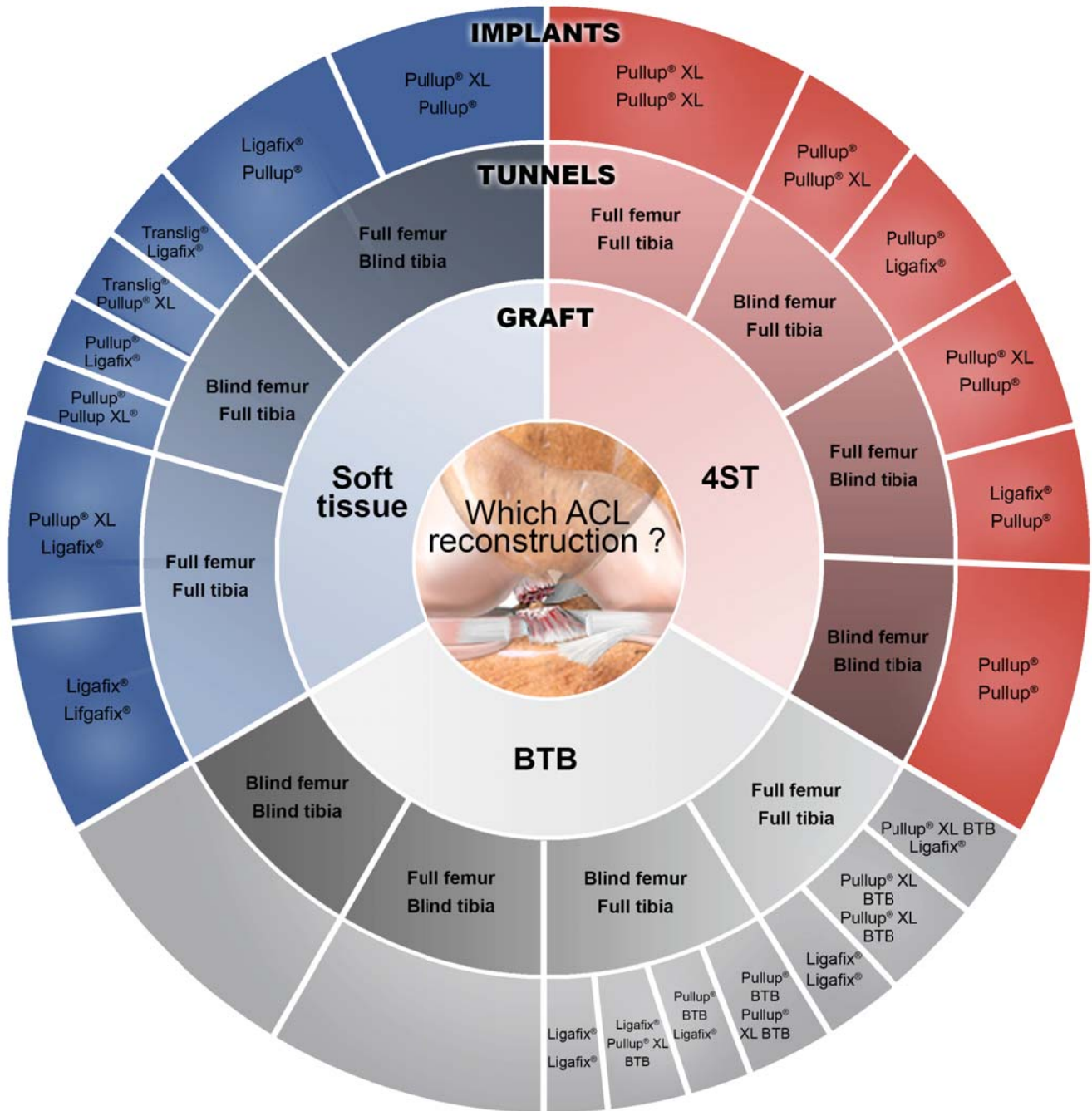

This figure shows which fixation you should use, depending on the type of graft and type of tunnels.

PULLUP[®] adjustable juxtacortical fixation system

Pull, flip, adjust.



<http://goo.gl/yqGUDi>

PULLUP[®]



Standard prepared loop: 40 mm

KEY FEATURES

- ▶ **Reproducible**
Controlled locking at blind tunnel endstop, conservation of bone stock.
- ▶ **Simple**
No pre-op planning of tunnel length, perioperative adjustment.
- ▶ **Reliable**
Stable locking system, renowned materials.

Pullup[®] system:

PULLUP[®] for \varnothing 4.5 mm cortical tunnel - PULLU01201
 PULLUP[®] XL for \varnothing 5 to 10 mm cortical tunnel - PULXL01202

Composition

Plate: Titanium Alloy
 Braids: UHMWPE (Ultra High Molecular Weight Polyethylene)
 Pull & flip sutures : PE polyester

PULLUP[®]



For cortical tunnels \varnothing 4.5 mm

PULLUP[®] XL



For cortical tunnels \varnothing 5 to 10 mm

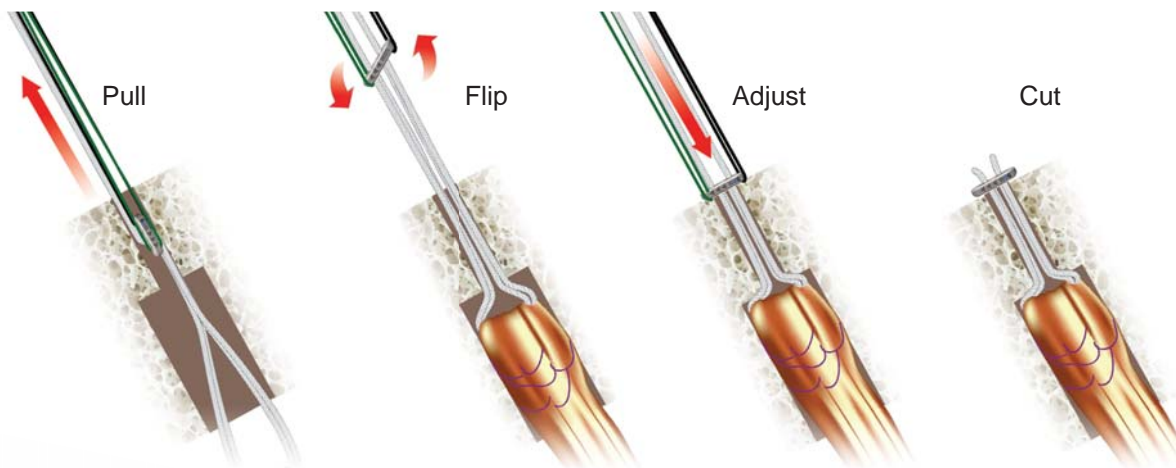

PULLUP[®] BTB

PULLUP[®] XL BTB

Adjustable juxta-cortical fixation for bone-tendon-bone grafts :

PULLUP BTB for \varnothing 4.5 mm cortical tunnel - PULLUK1201
 PULLUP XL BTB for \varnothing 5 to 10 mm cortical tunnel - PULXLK1202

PULLUP[®] TEX CLIP

PULLUP[®] CLIP



Pull up TEX CLIP - Loop only
 PULL00LOOP
 PULLUP CLIP - Connectable plate for \varnothing 4.5 mm cortical tunnel
 PULL0CT201
 PULLUP XL CLIP - Connectable plate for \varnothing 5 to 10 mm cortical tunnel
 PULXLCT202

PULLUP® instruments



∅ 4.5 mm cannulated drill bit
PULL000255

Cutting pliers
PULL000219

GraftTech® preparation station

The GraftTech® preparation station facilitates soft tissue graft preparation, particularly for PULLUP® constructs. It is composed of a regular base and optional add-ons depending of the type of graft to be prepared.



GraftTech® preparation station base instrumentation set mounted with brackets (including stainless steel basket and lid)

PULLTAB000

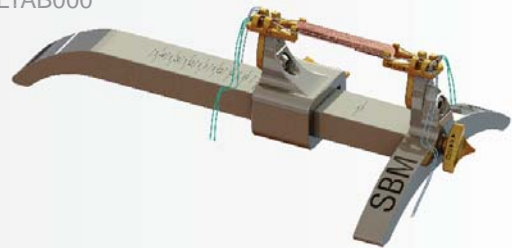

Options for GraftTech® preparation station

Mounting key - hex size 4 mm CLE9006004

Bracket for GraftTech® holder PULL00G217
Bracket for GraftTech® slider PULL00H217

GraftTech®

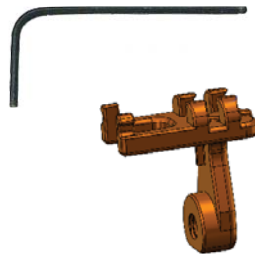

LIGAFIX®



REF PULL00E217

PULLUP®



REF PULL00H217

PULLUP®



REF PULL00G217

PULLUP®



REF PULL00H217

POWERTEX® Suture loaded with needle

The POWERTEX® suture loaded with needle can be used during ACL reconstruction to suture a single semitendinosus tendon harvest as well as a classic soft tissue transplant. Made up of a semicircular needle and size USP #2 / Length 90 mm UHMWPE (Ultra High Molecular Weight PolyEthylene) braid, POWERTEX® sutures are incredibly strong latest-generation sutures.

POWERTEX®

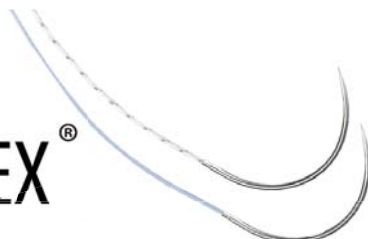

UHMWPE POWERTEX® Suture loaded with needle

BLUE - SUT00BLAG1

WHITE/BLACK - SUT00BNAG1

LIGAFIX® interference screws

Bioabsorbable and osteoconductive fixation



<http://goo.gl/rnwssA>

LIGAFIX®



KEY FEATURES

- ▶ **Bioabsorbable**
Made of Duosorb material, the implants are absorbed progressively and do not compromise future interventions.
- ▶ **Osteoconduction**
The high level of TCP promotes bone ingrowth.
- ▶ **Variety**
Ligafix® screws are available in numerous sizes, different compositions and various designs to match your technique.

LIGAFIX® 30

30% β -TCP + 70% PLDL

For all types of grafts, ideal for the BTB technique.
Optimizes mechanical strength, the screw is in direct contact with the bone plug.

LIGAFIX® 60

60% β -TCP + 40% PLDL

Only for soft tissue grafts.
Optimizes the kinetics of absorption.



Design

LIGAFIX® screws are available in two designs: round head and flat head to preserve the graft. The round head screws are suitable for tibial and femoral fixation while flat head screws are designed for tibial fixation.

2 heads for femoral and tibial fixation

Lengths: from 20 to 35 mm
Diameters : from 7 to 11 mm

Round head LIGAFIX® 30

Ø 6 mm, L 20 mm - COM3006020
Ø 6 mm, L 25 mm - COM3006025
Ø 7 mm, L 20 mm - COM3007020
Ø 7 mm, L 25 mm - COM3007025
Ø 7 mm, L 30 mm - COM3007030
Ø 8 mm, L 20 mm - COM3008020
Ø 8 mm, L 25 mm - COM3008025
Ø 8 mm, L 30 mm - COM3008030
Ø 8 mm, L 35 mm - COM3008035
Ø 9 mm, L 20 mm - COM3009020
Ø 9 mm, L 25 mm - COM3009025
Ø 9 mm, L 30 mm - COM3009030
Ø 9 mm, L 35 mm - COM3009035
Ø 10 mm, L 25 mm - COM3010R25
Ø 10 mm, L 30 mm - COM3010R30
Ø 10 mm, L 33 mm - COM3010R33
Ø 10 mm, L 35 mm - COM3010R35

Round head LIGAFIX® 60

Ø 7 mm, L 20 mm - COM6007020
Ø 7 mm, L 25 mm - COM6007025
Ø 7 mm, L 30 mm - COM6007030
Ø 8 mm, L 20 mm - COM6008020
Ø 8 mm, L 25 mm - COM6008025
Ø 8 mm, L 30 mm - COM6008030
Ø 8 mm, L 35 mm - COM6008035
Ø 9 mm, L 20 mm - COM6009020
Ø 9 mm, L 25 mm - COM6009025
Ø 9 mm, L 30 mm - COM6009030
Ø 9 mm, L 35 mm - COM6009035
Ø 10 mm, L 25 mm - COM6010R25
Ø 10 mm, L 30 mm - COM6010R30
Ø 10 mm, L 33 mm - COM6010R33
Ø 10 mm, L 35 mm - COM6010R35

Flat head LIGAFIX® 30 (only for tibia) Flat head LIGAFIX® 60 (only for tibia)

Ø 10 mm, L 30 mm - COM3010030
Ø 10 mm, L 35 mm - COM3010035
Ø 11 mm, L 30 mm - COM3011030
Ø 11 mm, L 35 mm - COM3011035

Ø 10 mm, L 30 mm - COM6010030
Ø 10 mm, L 35 mm - COM6010035
Ø 11 mm, L 30 mm - COM6011030
Ø 11 mm, L 35 mm - COM6011035

Reminder:

Round head screws

Femoral end: preserves the graft during articular flexion.
Tibial end: ensures optimal locking.

LIGAFIX® 30

The tunnel must be drilled at a diameter that is adapted to the screw's diameter and to the technique used:
BTB: The Ø of the screw must be 1mm less than the Ø of the drill.
Hamstring: The Ø of the screw must be equal to the Ø of the drill.

Flat head screws

Only for tibia.
Insertion facilitated at the end of screwing.

LIGAFIX® 60

Only for hamstring grafts.
The diameter of the screw must be at least equal to the drill's diameter.

LIGAFIX® instruments



Guide pin introducer for guide pin \varnothing 0.9 mm

LIG9000092



Rigid guide pin L 300 mm:

\varnothing 0.9 mm for \varnothing 6, 7, 8 mm screwdriver (x 2) - LIG9109300
 \varnothing 1.4 mm for \varnothing 9, 10, 11 mm screwdriver (x 2) - LIG9114300



Tap screwdriver:

Grey for \varnothing 6 mm screws - LIG9000296 (*optional*)
White for \varnothing 7 mm screws - LIG9000169
Black for \varnothing 8, 9, 10, 11 mm screws - LIG9000093



Screwdriver:

Grey for \varnothing 6 mm screws - LIG9009017 (*optional*)
Green for \varnothing 7, 8 mm screws - LIG9008046
Blue for \varnothing 9, 10, 11 mm screws - LIG9009017



Standard instruments for ligament reconstruction

Tibial aiming device

LIG9000034



Guide pin sleeve for aiming device

LIG9000032



Graft gauge - half sizes

LIG9000266



Stopper

LIG9000051



Cannulated drill bit (long flute) L=60 mm:

\varnothing 6 mm - LIG9006289
 \varnothing 7 mm - LIG9007289
 \varnothing 8 mm - LIG9008289
 \varnothing 9 mm - LIG9009289
 \varnothing 10 mm - LIG9010289
 \varnothing 11 mm - LIG9011289



Guide pin (K-Wire) \varnothing 2.5 mm for drill bits

LIG9125300



LIGAFIX® - PULLUP® stainless steel basket with silicones

PULLIGPA02



Outside-Inside instrument (femoral approach)

Femoral aiming device

LIG9000029

LIGAFIX® complete Outside Inside instrumentation set

LIG90DD000

Blind Tunnel instruments (femoral approach)

Eyelet pin L 400 mm

LIG9000041

Pistol-grip femoral aiming device:

∅ 9 mm - LIG9009B45

∅ 10 mm - LIG9010B45

LIGAFIX® complete Blind Tunnel instrumentation set

LIG90TB000

Optional instruments

LIGAFIX ratchet screwdriver handle

LIG9000312

LIGAFIX ratchet screwdriver rod

∅ 6 mm - LIG9000317

∅ 7/8 mm LIG9000310

∅ 9/10/11 mm - LIG9000311

LIGAFIX ratchet tap rod

∅ 6 mm - LIG9000318

∅ 7/8 mm LIG9000319

∅ 9/10/11 mm - LIG9000320

SBM closed stripper

LIG90FSTRI

SBM open stripper

LIG90OSTRI

SN-SBM stripper

LIG9013554

WOLF-SBM stripper

8866.951





Chondral pick

LIG9000190

Lanceolate Rigid guide pin L 400 mm

LIG9000U41

Half-size Cannulated drill bit (long flute) L=60 mm:

- ø 6.5 mm - LIG9065289
- ø 7.5 mm - LIG9075289
- ø 8.5 mm - LIG9085289
- ø 9.5 mm - LIG9095289
- ø 10.5 mm - LIG9105289

Routers:

- ø 6.5 mm - LIG9065072
- ø 7 mm - LIG9070072
- ø 7.5 mm - LIG9075072
- ø 8 mm - LIG9080072
- ø 8.5 mm - LIG9085072
- ø 9 mm - LIG9090072
- ø 9.5 mm - LIG9095072
- ø 10 mm - LIG9010072
- ø 10.5 mm - LIG9010572
- ø 11 mm - LIG9011072

Non cannulated drill bit ø4,5mm

LIG9045FOR

LARS® Retrograde drill bits:

- ø 7 mm - D39001
- ø 8 mm - D39002
- ø 9 mm - D39003
- ø 10 mm - D39004
- ø 11 mm - D39005

Tool for hand retrodrill activation

PULL000292

PULLUP® stopper

LIG9000267

Suture retriever pliers

LIG906012T

LIGAFIX® - PULLUP® stainless steel basket lid

PULLIGPA01



TRANSLIG® cross pins

Bioabsorbable and strong femoral fixation



TRANSLIG® cross pin:

- ∅ 5 mm, L 40 mm - COM60TR540
- ∅ 5 mm, L 50 mm - COM60TR550
- ∅ 5 mm, L 60 mm - COM60TR560
- ∅ 6 mm, L 40 mm - COM60TR640
- ∅ 6 mm, L 50 mm - COM60TR650
- ∅ 6 mm, L 60 mm - COM60TR660

KEY FEATURES

- ▶ **Bioabsorbable**
Made of Duosorb material, the implants are progressively absorbed within 12 to 18 months without adverse reactions.
- ▶ **Strong**
Two cross pins are 45% more resistant and 90% more rigid than interference screws.
- ▶ **360° graft contact**
The contact between the implant and the graft enhances biological integration of the graft in the tunnel.



<http://goo.gl/ff5o6g>

TRANSLIG® instrumentation for ligament cross pin fixation

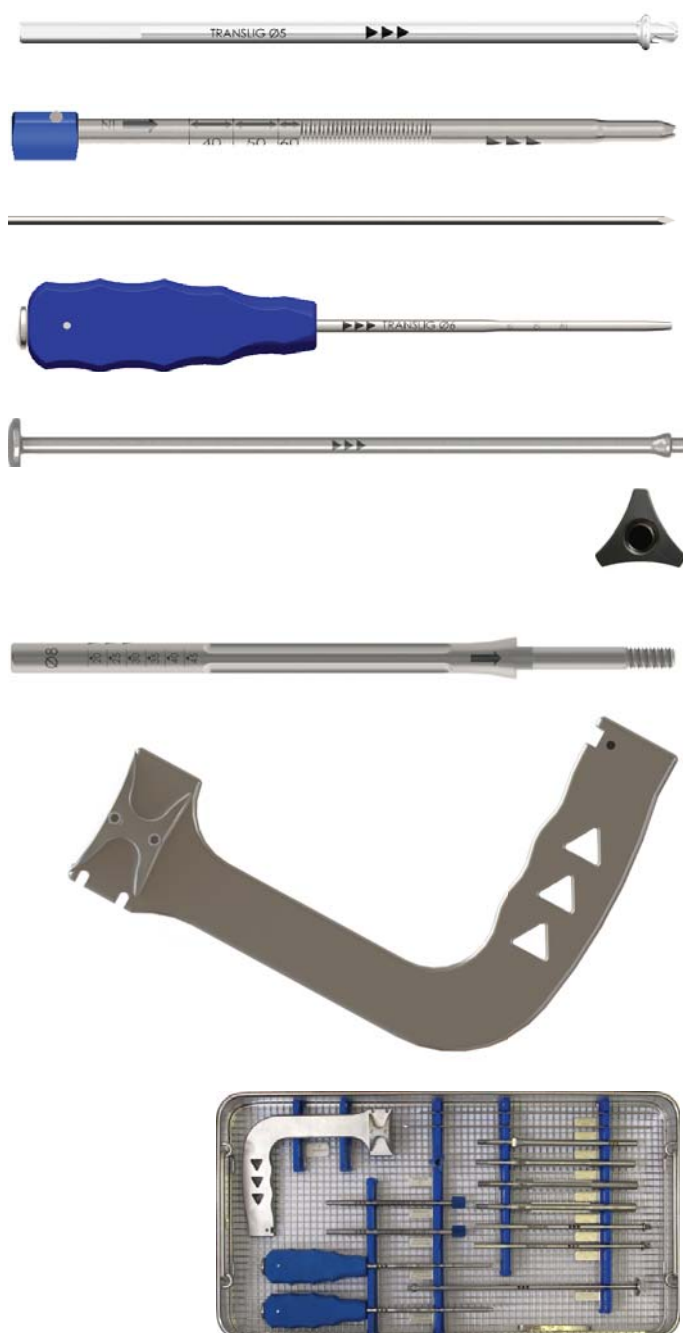

Lock drill:

- ∅ 5 mm - TRA9005160
- ∅ 6 mm - TRA9000160

Transverse guide pin sleeve for aiming device (x2) TRA9000159

Transverse guide pin ∅ 2.5 mm - L 270 mm (x2) TRA9025270

Dilator:

- ∅ 5 mm - TRA9005168
- ∅ 6 mm - TRA9006168

Cross pin impactor TRA9000161

Femoral shaft nut TRA9000162

Femoral shaft:

- ∅ 7 mm - TRA9007158
- ∅ 8 mm - TRA9008158
- ∅ 9 mm - TRA9009158
- ∅ 10 mm - TRA9010158

Transverse femoral aiming device TRA9000157

TRANSLIG® stainless steel basket with silicone holders TRA9000001

TRANSLIG® complete instrumentation set TRA9000000

Bibliography

- 1 Comparison of resorption and remodeling of bioabsorbable interference screws in anterior cruciate ligament reconstruction**
NTAGIOPOULOS P-G, DEMEY G., TAVEMIERT., DEJOUR D.
International Orthopaedics (SICOT) DOI 10.1007/s00264-014-2530-8, 2014
- 2 Are the tubular grafts in the femoral tunnel in an anatomical or isometric position in the reconstruction of medial patellofemoral ligament?**
NTAGIOPOULOS P-G, SHAMA B., BIGNOZZI S, LOPOMO N., COLLE, F., ZAFFAGNINI S., DEJOUR D.
International Orthopaedics (SICOT) DOI 10.1007/s00264-013-1938, 2013
- 3 A new technique in double-bundle anterior cruciate ligament reconstruction using implant-free femoral fixation**
PRADO R-K, NTAGIOPOULOS P-G, FUCS P-M-B, SEVERINO N-R, DEJOUR D.
International Orthopaedics, Volume 36, Number 7, 1479-1485, 2012
- 4 Bone-patellar tendon-bone graft via a single minimally-invasive approach versus a classical approach in anterior cruciate ligament reconstruction**
IONCU A., MADER R., BONIN N, TERNAMIAN P-J., DEJOUR D.
Orthopaedics & Traumatology: Surgery & Research 98, 426—431, 2012
- 5 Knee laxity control in revision Anterior Cruciate Ligament reconstruction versus Anterior Cruciate Ligament reconstruction and lateral tenodesis**
COLOMBET P.
The American Journal of Sports Medicine, vol. 39 no. 6 1248-1254, 2011
- 6 Interest of an osteoconductive material in graft healing of acl reconstruction with the Hamstring Tendon**
ROBERT H.
SOFOT 2010
- 7 Biological performance of a new β -TCP - PLLA composite material for applications in spine surgery: in vitro and in vivo studies**
AUNOBLE S., CLEMENT D., FRAYSSINET P., HARMAND M-F., LE HUEC J-C.
Journal of Biomedical Materials Research, Part A, Art. 30749, 1-7, 2006

About SBM

SBM (Science for BioMaterials) has been specialized in the design, manufacture and distribution of biomaterials for bone surgery since 1991. The company's priority is the development and optimization of medical devices which promote bone healing and human tissue replacement.

By completely controlling its technique in biomaterials, the company elaborates a range of innovative, 100% synthetic and absorbable systems along with specific ancillary instrumentation. Firmly established on the French domestic market, SBM has expanded its activities abroad in more than 40 countries for the sales and development of new products, in order to better meet the demands of the medical industry worldwide.



SBM SAS

ZI du Monge
65100 LOURDES
FRANCE
Phone: (+33) 5 62 42 32 12
Fax: (+33) 5 62 42 32 52
www.sbm-france.com

SBM, INC.

(Subsidiary)
19 Hancock Street #2
WINCHESTER, MA 01890
USA
Phone: (+1) 781 369 1782
www.sbm-france.us



Carefully read the instructions for use that come with the medical devices and labeling provided to medical professionals.
Document not legally binding - Can be modified without prior notice.
Manufactured by SBM © 2015. Ref: MGBVFCAEN - v5.0117

Distributed by